



# INSTALLATION GUIDE

Watch on Youtube:

哔哩哔哩观看安装视频



EN RU CN

X3A9D13-V1

A10-V6-GM



## Component List

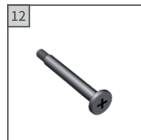
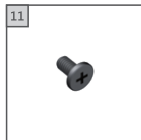
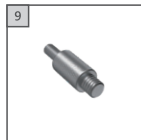
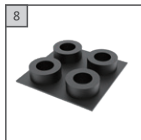
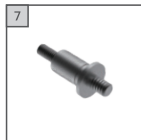
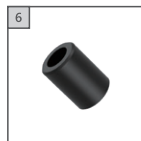
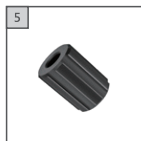
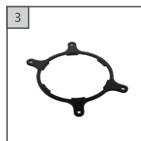
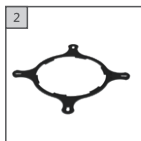
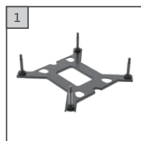

### EN

- 1) LGA1700/1200 Backplate
- 2) Intel Bracket
- 3) AMD Bracket
- 4) Tightening Nut
- 5) LGA1700 Standoff
- 6) LGA1200/115X Standoff
- 7) AMD Standoff
- 8) Plastic Insulaor
- 9) LGA20xx Standoff
- 10) Thermal Grease
- 11) Radiator Mounting Screw
- 12) Fan Mounting Screw

### RU

- 1) LGA1700/1200 Задняя панель
- 2) Intel Кронштейн
- 3) AMD Кронштейн
- 4) Затяжная гайка
- 5) LGA1700 Стопор
- 6) LGA1200/115X Стопор
- 7) Крепежные стойки AMD
- 8) Пластиковый изолятор
- 9) LGA20xx Стопор
- 10) Термопаста
- 11) Крепежные болты для радиатора
- 12) Крепежные болты для вентилятора

### CN

- 1) LGA1700/1200 背板
- 2) Intel 支架
- 3) AMD 支架
- 4) 紧固螺母
- 5) LGA1700 胶柱
- 6) LGA1200/115X 胶柱
- 7) AMD 螺栓
- 8) 垫片
- 9) LGA20XX 螺栓
- 10) 导热膏
- 11) 冷排螺丝
- 12) 风扇螺丝

Choose Components for Sockets:

LGA1700: **1** **2** **4** **5** **10**

AMD AM4/AM5: **3** **4** **7** **8** **10**

LGA1200/115X: **1** **2** **4** **6** **10**

## Intel Bracket Illustration

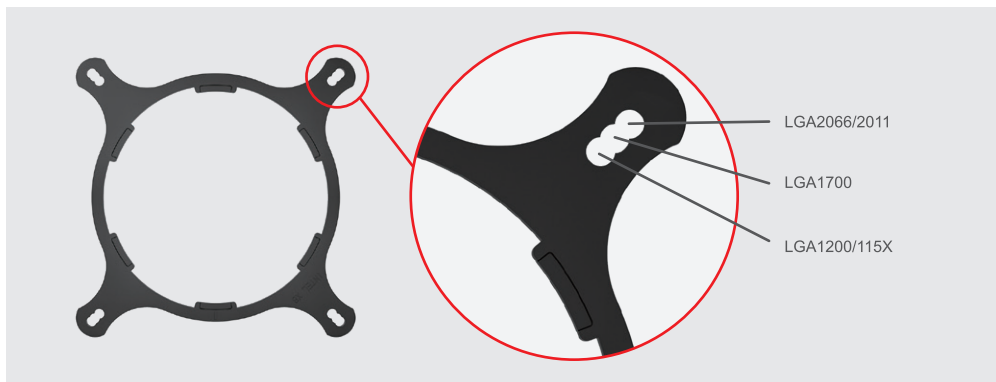

## Intel Backplate Illustration

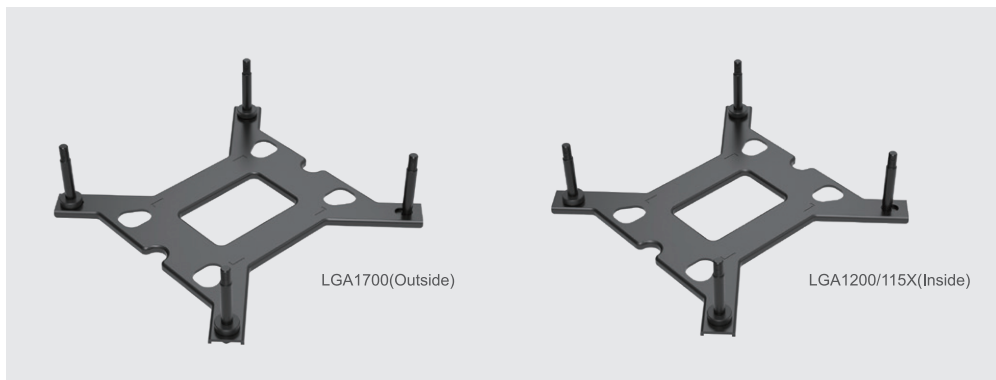

## Change logo orientation / directions



**EN**

Change logo orientation / directions:

Turn off the cap clockwise and adjust the angle as needed and then turn it counterclockwise to lock it back to position.

**RU**

Изменение угла наклона логотипа:

Открутите крышку по часовой стрелке и отрегулируйте угол наклона логотипа по мере необходимости, а затем закрутите крышку обратно против часовой стрелки, чтобы вернуть её в исходное положение.

**CN**

LOGO方向校正:

顺时针拧下冷头盖, 调整方向然后放入逆时针卡回去即可。

### Intel Mounting

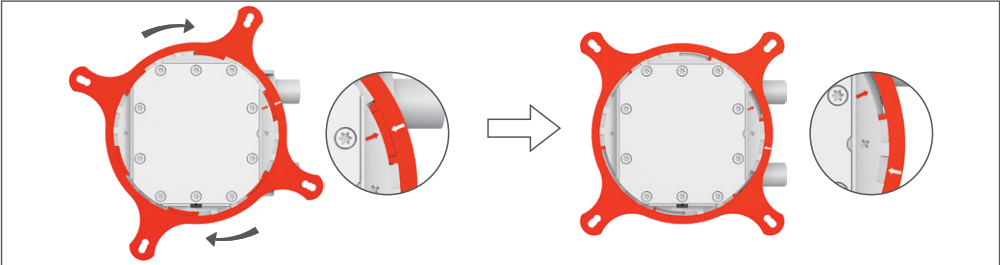

### Intel LGA 1700

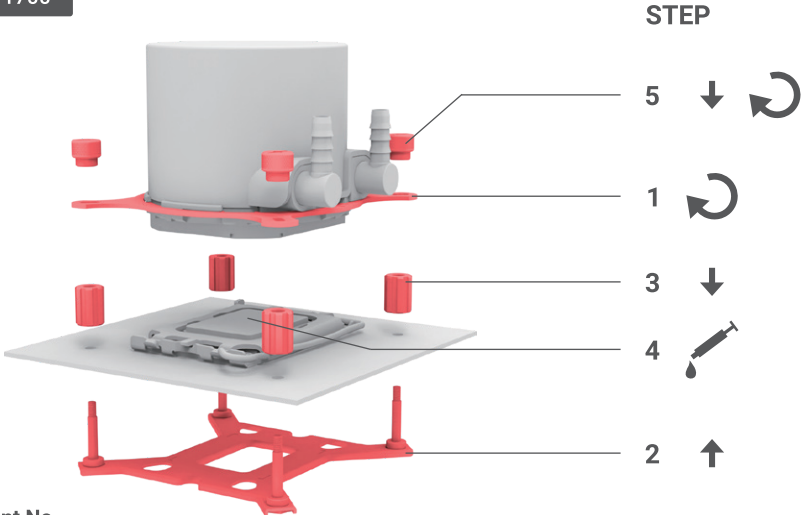

Component No.

- 1
- 2
- 4
- 5
- 10

### Intel Mounting

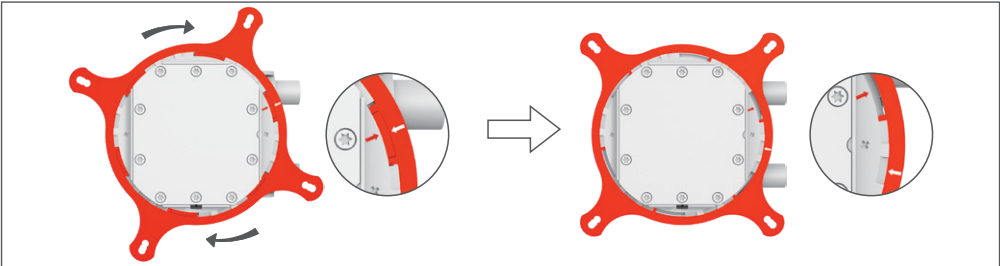

### Intel LGA 1200/115X

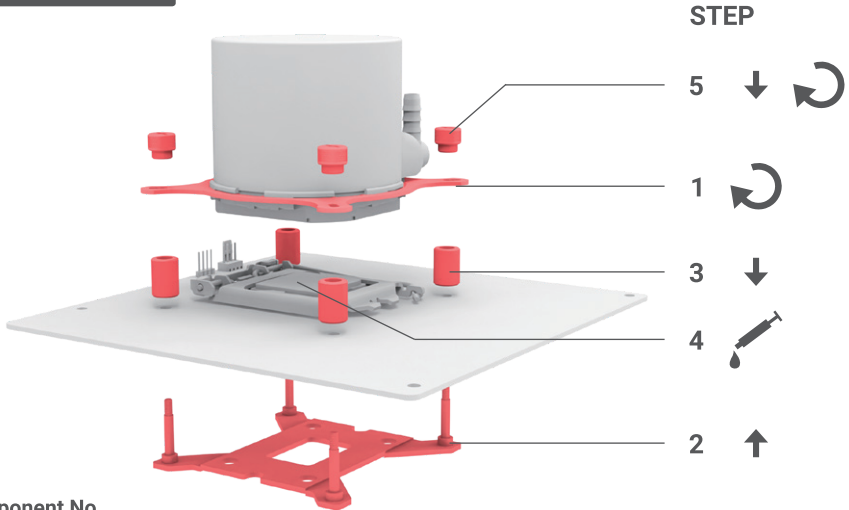

Component No.

- 1
- 2
- 4
- 6
- 10

AMD AM4/AM5

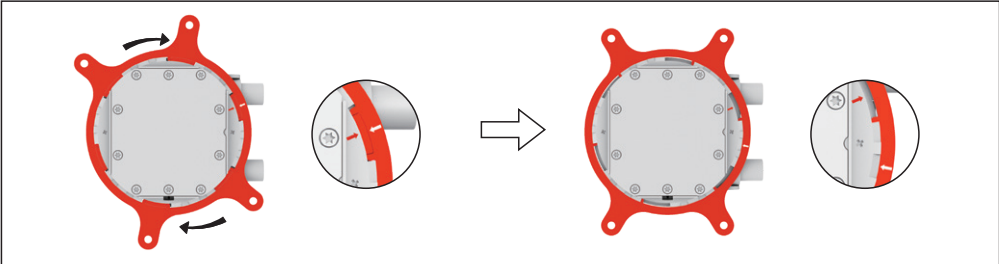

AMD AM4/AM5

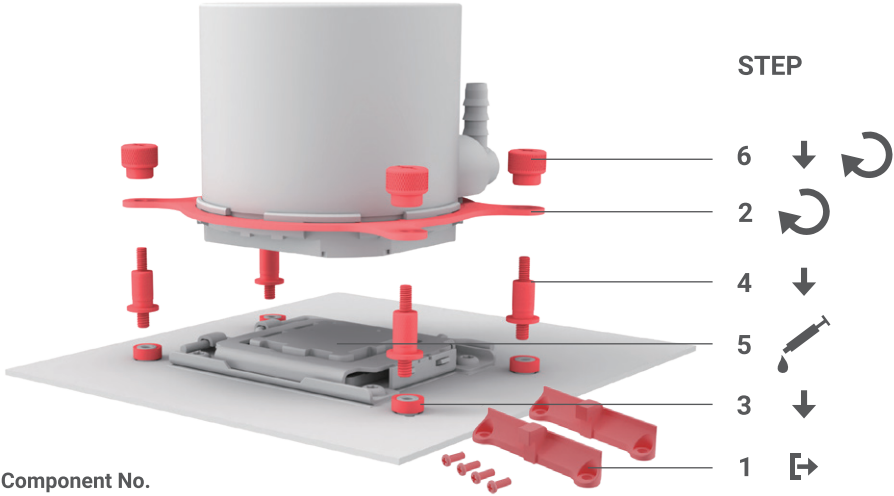

Component No.

- 3
- 4
- 7
- 8
- 10



# Fan Connection

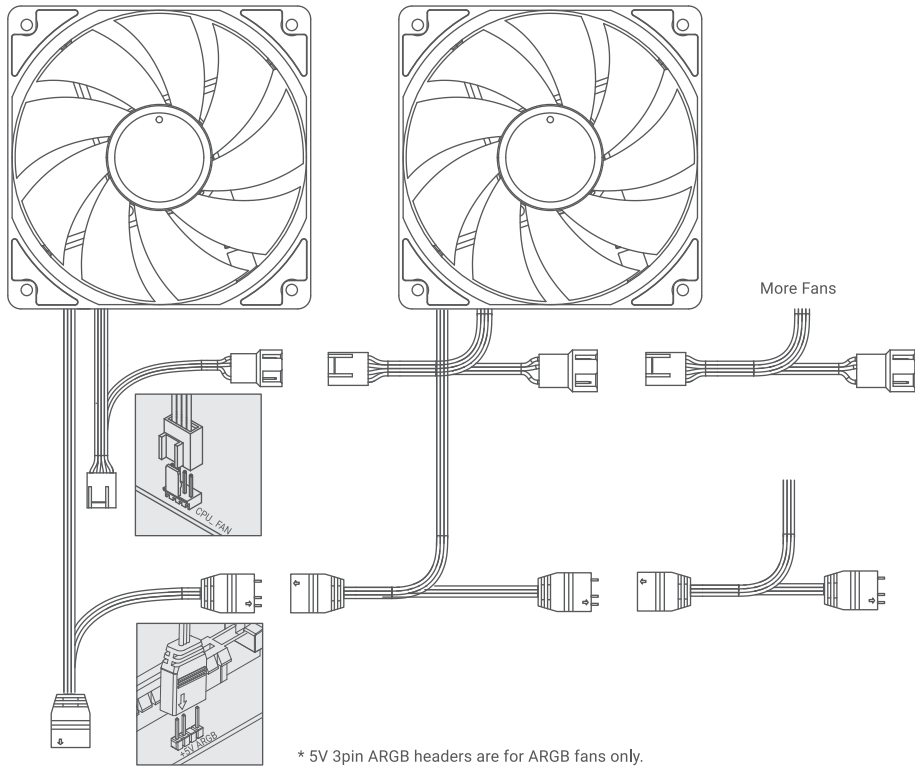

ASUS: ADD\_HEADER



MSI: JRAINBOW



GIGABYTE: D\_LED



ASROCK: ADDR\_LED

# Have Questions ?

- Please ask for professional help if you don't know how to install.
- Make sure you're working on a power-off PC.
- If you have any doubt about components list or product itself, please contact your original reseller/retailer/etailer.
- ID-COOLING is always ready to offer our support. You can find the contact information below.
- Descriptions are for your reference. Different models may vary in terms of components list.

SHENZHEN BUYEASY CO., LTD.

[www.idcooling.com](http://www.idcooling.com)

[support@idcooling.com](mailto:support@idcooling.com)





